

| REV | DATE | ECO | DESCRIPTION | BY | CK | APP |
|-----|--------|-----|-----------------|-----|----|-----|
| - | 6/6/02 | NA | INITIAL RELEASE | CRP | NA | NA |

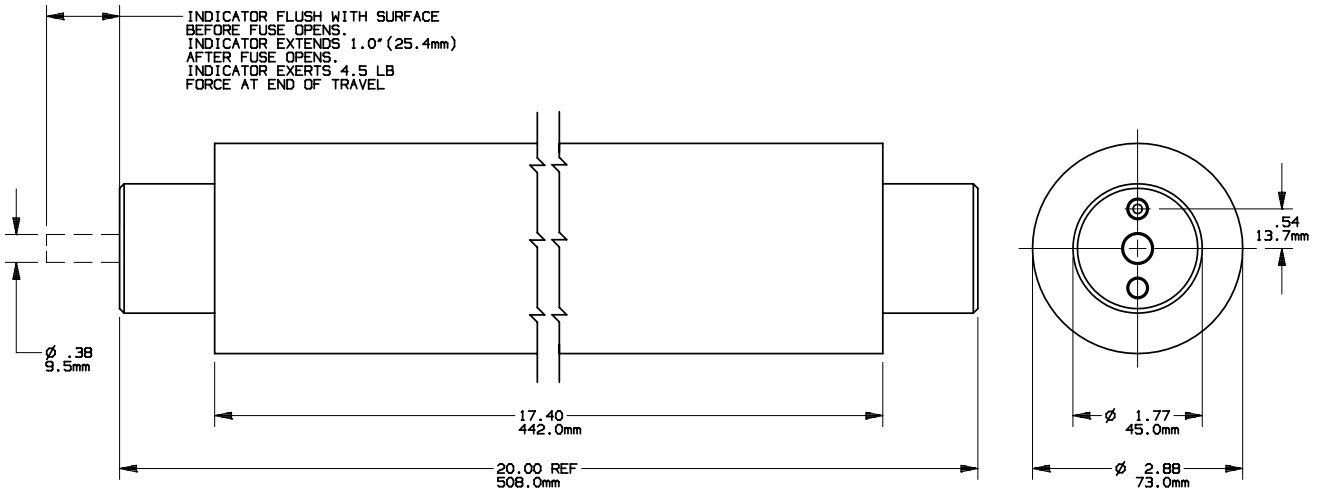

| | |
|--------|----------------|
| 19R | A072D1DSR0-19R |
| 16R | A072D1DSR0-16R |
| 13R | A072D1DSR0-13R |
| 12R | A072D1DSR0-12R |
| 9R | A072D1DSR0-9R |
| 6R | A072D1DSR0-6R |
| 5R | A072D1DSR0-5R |
| 4R | A072D1DSR0-4R |
| 3R | A072D1DSR0-3R |
| 2R | A072D1DSR0-2R |
| RATING | CATALOG NUMBER |

Ferraz Shawmut
 FERRAZ SHAWMUT INC.
 374 MERRIMAC STREET
 NEWBURYPORT, MA 01950

MEDIUM VOLTAGE "R" RATED
 MOTOR CIRCUIT BACKUP
 CURRENT LIMITING FUSE
 IEC DIN TYPE 2R TO 19R 7.2kVMAX

OUTLINE DIMENSIONS
 NOT TO BE USED FOR PRODUCTION

| | |
|-----------------|-----------------|
| PRODUCT MANAGER | DESIGN ENGINEER |
| SIGN: | SIGN: |
| DATE: | DATE: |

700730