

| REV | DATE    | ECO | DESCRIPTION     | BY  | CK  | APP |
|-----|---------|-----|-----------------|-----|-----|-----|
| -   | 4-15-99 | N/A | INITIAL RELEASE | LDB | N/A | N/A |

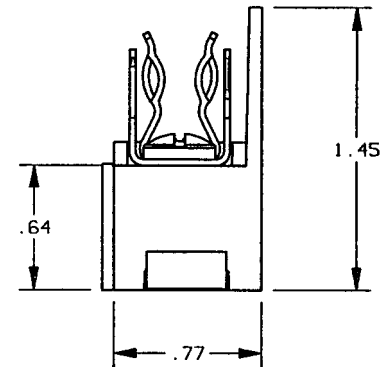
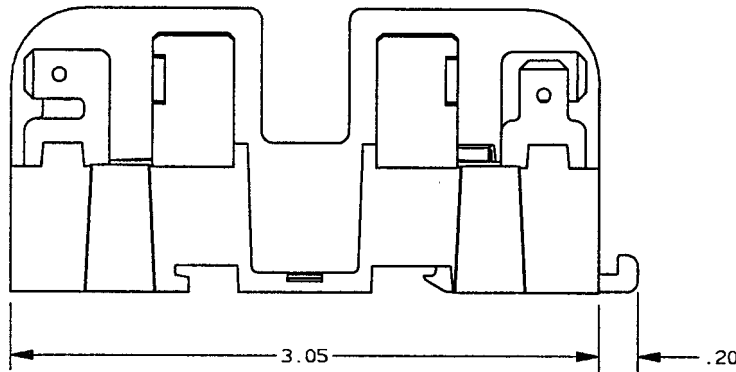
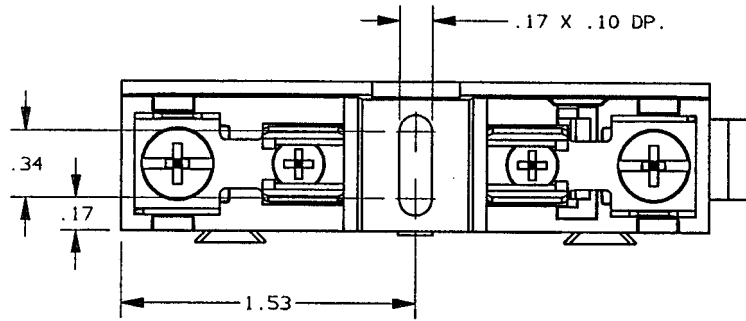

NOTES:

1. MATERIAL COMPOSITION AND RATING:  
BASE - THERMOPLASTIC 125°C RTI
2. ALL TOLERANCES ±.010 UNLESS OTHERWISE NOTED

| P/N    | CONN TYPE | RMS SYM RATING | TORQUE (IN-LBS) | WIRE  |         | U/L      |           | CSA        |
|--------|-----------|----------------|-----------------|-------|---------|----------|-----------|------------|
|        |           |                |                 | °C    | TYPE    | FILE NO. | GUIDE NO. | REPORT NO. |
| 40210G | SCREW     | 100K           | 20              | 60/75 | CU ONLY | E52283   | 1ZLT      | LR32169    |

**GOULD** 374 MERRIMAC STREET  
NEWBURYPORT, MA 01950

PRODUCT MANAGER

SIGN: *Nick Diller*  
DATE: 5-10-99

DESIGN ENGINEER

SIGN: *Shabeta Gya*  
DATE: 5/10/99

FUSE BLOCK, 600V-20A, ADDER  
CLASS G

OUTLINE DIMENSIONS  
NOT TO BE USED FOR PRODUCTION

700456