

SURGE TRAP DIN RAIL TVSS

SURGE SUPPRESSION



DIN RAIL TVSS (THERMALLY PROTECTED)

The Surge Trap TVSS from Ferraz Shawmut is an innovative enhancement to the existing TPMOV (Thermally Protected MOV) Product line. The Surge-Trap provides a patented, thermally protected MOV that does not require additional overcurrent protection, due to the high interrupting rating.

It also offers the flexibility to be connected individually or ganged together. Each individual mode has a visual and remote indicator to provide status to critical control circuits.

APPLICATION:

- Transient Voltage Surge Suppressors
- AC/DC Distribution
- High Voltage Power Supplies
- Telecom
- Motor Control Systems
- PLC Applications
- Power Transfer Equipment

Ratings

- MCOV 150 to 550
- 50kA 8/20us Capacity per mode

Approvals

- UL 1449 Second Edition Component Recognition

Dimensions

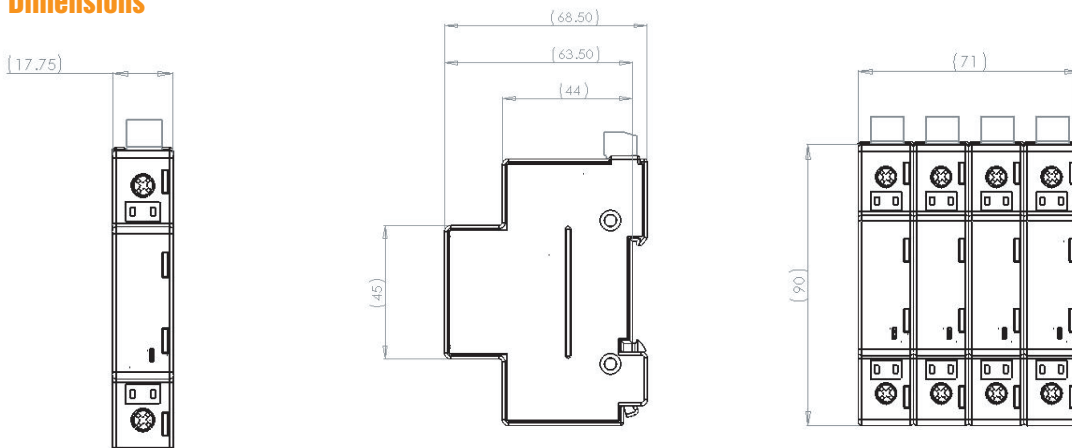

Features/Benefits

- High Energy Capacity
- Din-Rail Mountable (35mm)
- IP20 - Fingersafe
- Built in Visual/Remote Indication
- Built in Thermal Protection
- 100kA Interrupting Rating

SURGE TRAP DIN RAIL TVSS

SURGE SUPPRESSION

Surge Trap Selection guide:

- STEP 1:** Select electrical voltage configuration from first column
- STEP 2:** Select proper modes of protection from third column
- STEP 3:** Select corresponding catalog number from fourth column
- STEP 4:** Add an M to the catalog number if you require remote indication

Voltage Configuration	Wires	Protection Modes	Catalog Number	Figure	MCOV	Surge Capacity					UL Clamping Voltage 6kV - 3kA				UL 1449-2 SVR			
						L-G	Mode	L-G	N-G	L-L	Phase	L-N	L-G	N-G	L-L	L-N	L-G	N-G
120V Single Phase	2 Wire + Grnd	L-N / L-G Only	ST1201PG (M)	A	180V	50KA	50KA	-	-	-	500V	500V	-	-	500V	500V	-	-
230V Single Phase	2 Wire + Grnd	L-N / L-G Only	ST2301PG (M)	A	270V	50KA	50KA	-	-	-	800V	800V	-	-	800V	800V	-	-
277V Single Phase	2 Wire + Grnd	L-N / L-G Only	ST2771PG (M)	A	320V	50KA	50KA	-	-	-	1000V	1000V	-	-	900V	900V	-	-
120/208V Split Phase	3 Wire + Grnd	L-L/L-N/L-G	ST208SPG (M)	B	180V	50KA	50KA	-	50KA	100KA	500V	500V	-	1000V	500V	500V	-	1000V
120/240V Split Phase	3 Wire + Grnd	L-L/L-N/L-G	ST240SPG (M)	B	180V	50KA	50KA	-	50KA	100KA	500V	500V	-	1000V	500V	500V	-	1000V
240/480V Split Phase	3 Wire + Grnd	L-L/L-N/L-G	ST480SPG (M)	B	270V	50KA	50KA	-	50KA	100KA	800V	800V	-	1600V	800V	800V	-	1500V
120/208V 3-ph Wye	4 Wire + Grnd	L/L-N/L-G/N-G	ST2083PY (M)	E	360V	50KA	50KA	50KA	50KA	100KA	500V	1000V	500V	1000V	900V	500V	500V	1000V
120/208V 3-ph Wye	4 Wire + Grnd	L-L/L-N/L-G	ST2083PYG (M)	C	180V	50KA	50KA	-	50KA	100KA	500V	500V	-	1000V	500V	500V	-	1000V
277/480V 3-ph Wye	4 Wire + Grnd	L/L-N/L-G/N-G	ST4803PY (M)	E	500V	50KA	50KA	50KA	50KA	100KA	1000V	1500V	500V	2000V	900V	1400V	500V	1800V
277/480V 3-ph Wye	4 Wire + Grnd	L-L/L-N/L-G	ST4803PYG (M)	C	320V	50KA	50KA	-	50KA	100KA	1000V	1000V	-	2000V	900V	900V	-	1800V
347/600V 3-ph Wye	4 Wire + Grnd	L/L-N/L-G/N-G	ST6003PY (M)	E	690V	50KA	50KA	50KA	50KA	100KA	1500V	2300V	800V	3000V	1200V	2000V	800V	2500V
347/600V 3-ph Wye	4 Wire + Grnd	L-L/L-N/L-G	ST6003PYG (M)	C	420V	50KA	50KA	-	50KA	100KA	1500V	1500V	-	3000V	1200V	1200V	-	2500V
240V 3-ph Delta	3 Wire + Grnd	L-L Only	ST2403PD (M)	D	N/A	50KA	-	-	50KA	-	-	-	-	1000V	-	-	-	800V
240V 3-ph Delta	3 Wire + Grnd	L-L / L-G	ST2403PDG (M)	C	270V	50KA	50KA	-	50KA	100KA	-	800V	-	1600V	-	800V	-	1500V
480V 3-ph Delta	3 Wire + Grnd	L-L Only	ST4803PD (M)	D	N/A	50KA	-	-	50KA	-	-	-	-	1850V	-	-	-	1500V
480V 3-ph Delta	3 Wire + Grnd	L-L / L-G	ST4803PDG (M)	C	550V	50KA	50KA	-	50KA	100KA	-	1850V	-	3700V	-	1500V	-	3000V

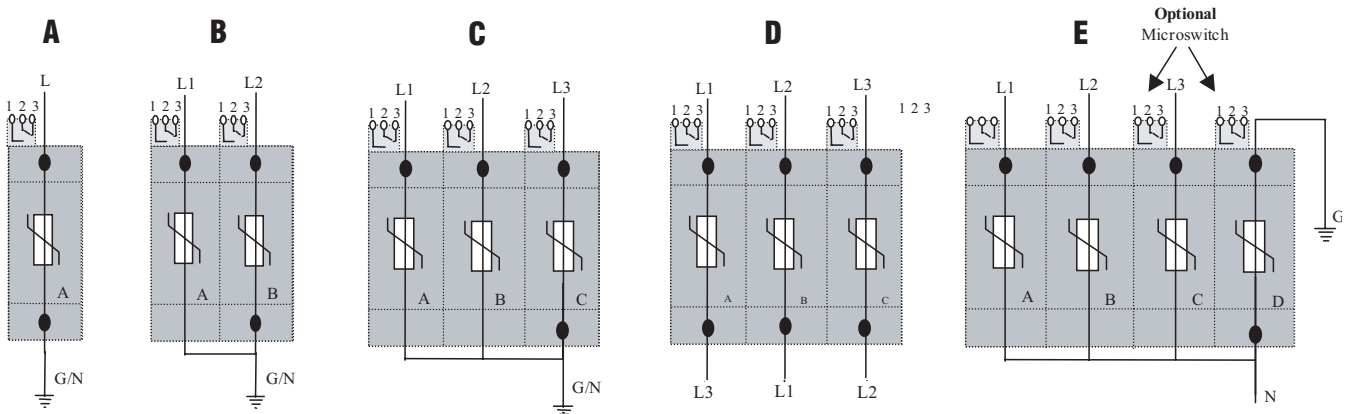

Electrical Voltage Configurations

