

CLASS CA & CB

CN, CNS/CANADIAN FUSES

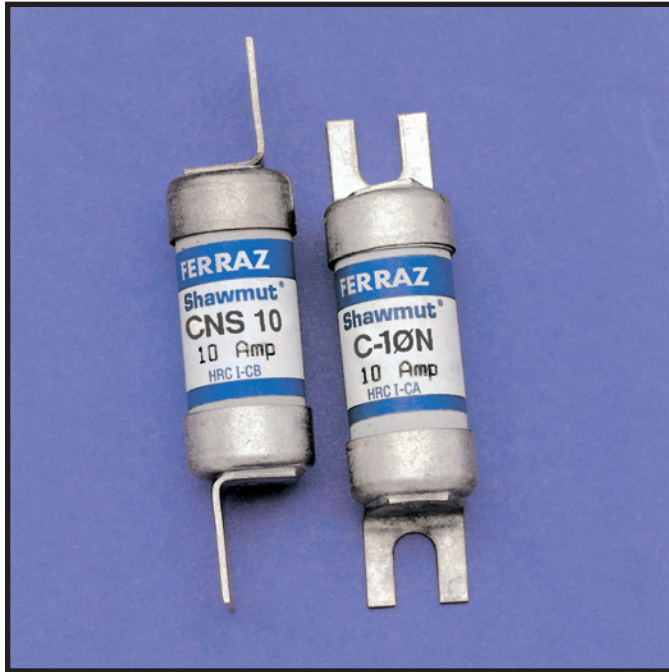

CLASS CA AND CB FUSES

Ferraz Shawmut Canadian Class CA and CB fuses are bolt-in type, interchangeable with older Canadian Form I/HRCI fuses for exact replacement. They are not interchangeable with other North American fuses. CA and CB fuses are full-range, current-limiting fuses with a high interrupting rating.

Ratings

- **AC:** 1 to 30A
600VAC, 200kA I.R.

Approvals

- CSA Certified to Standard C22.2, No. 248.3

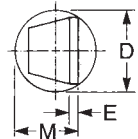
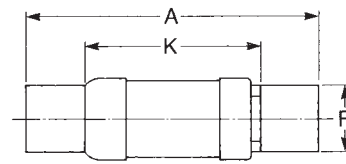
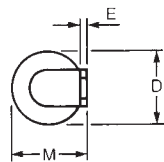
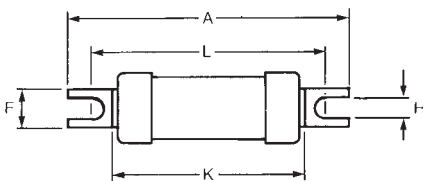

Class CA – Catalog Numbers & Dimensions

AMPERE RATING	CATALOG NUMBER	DIMENSIONS in mm							
		A	D	E	F	H	K	L	M
1	C1N								
3	C3N								
6	C6N	62	13.9	0.8	11.1	4.7	36.5	44.5	14.3
10	C10N								
15	C15N								
20	C20N								

Class CB – Catalog Numbers & Dimensions

AMPERE RATING	CATALOG NUMBER	DIMENSIONS in mm					
		A	D	E	F	K	M
1	CNS1						
3	CNS3						
6	CNS6						
10	CNS10	62	14.5	0.8	11.0	35.5	11.65
15	CNS15						
20	CNS20						
25	CNS25						
30	CNS30						

Class CA & CB – I²t at 200kA

CATALOG NUMBER	I ² t (A ² Secs.)		
	PRE-ARC	@ 460V	@ 600V
C3N, CNS3	0.8	1.5	2.2
C6N, CNS6	7.6	15	21
C10N, CNS10	40	76	110
C15N, CNS15	130	280	370

Call for technical information