

REV	DATE	ECO	DESCRIPTION	BY	CK	APP
-	10-26-98	N/A	INIT RELEASE	GCT	N/A	N/A

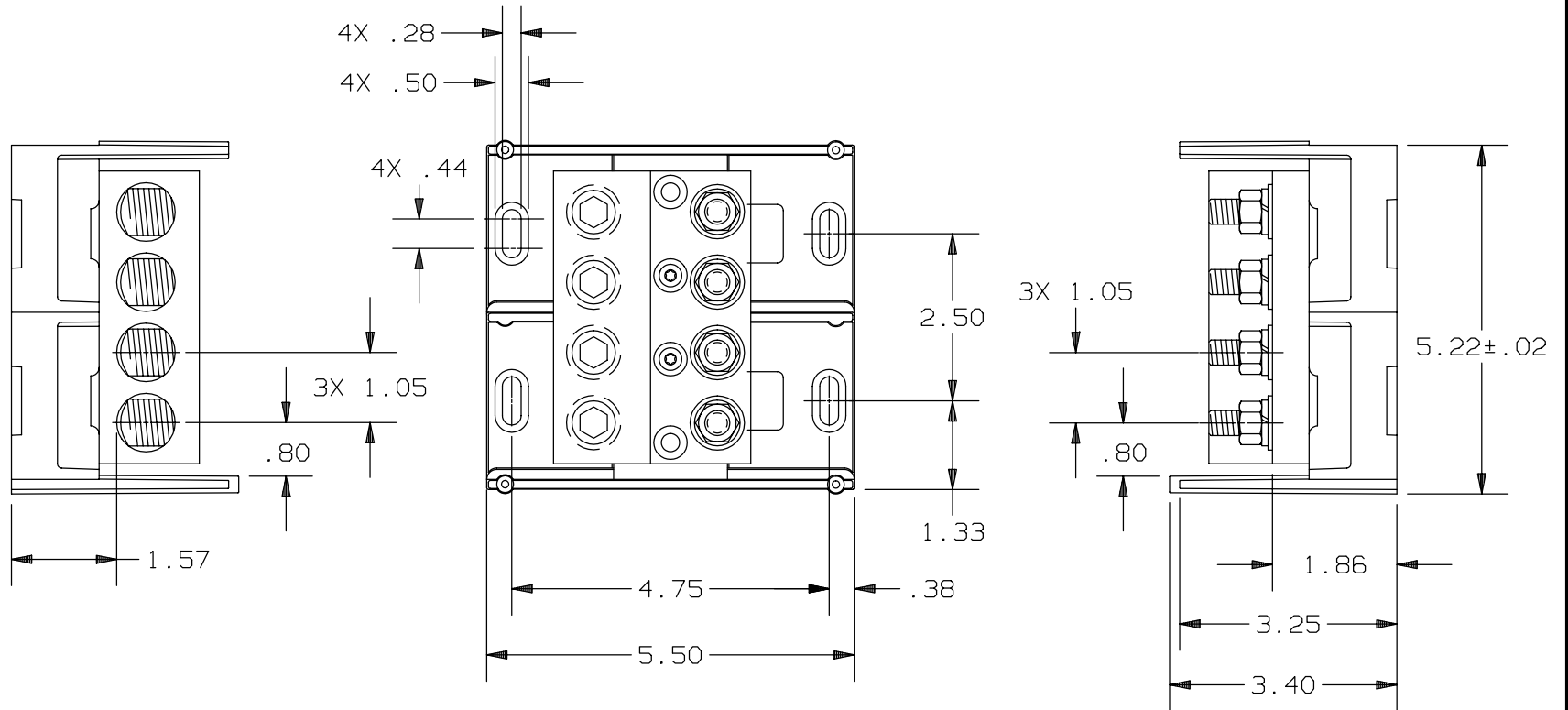

NOTES:

1. MATERIAL COMPOSITION AND RATING:
BASE - THERMOPLASTIC 125°C RT1
CONNECTOR - ALUMINUM OR COPPER ALLOY W/TIN PLATE.
2. TOLERANCES ARE ±.01 UNLESS OTHERWISE SPECIFIED.

P/N 900091 (CU-AL)

P/N	WIRE RANGE & TORQUE (IN-LBS)				AMPACITY
	PRIMARY		SECONDARY		AMPS
	RANGE	TORQUE	RANGE	TORQUE	
900091	500 kcmil-#4	500	3/8 STUD	228	1520



MERSEN USA NEWBURYPORT-MA, LLC
374 MERRIMAC STREET
NEWBURYPORT, MA 01950

POWER DISTRIBUTION BLOCK

OUTLINE DIMENSIONS
NOT TO BE USED FOR PRODUCTION

PRODUCT MANAGER

DESIGN ENGINEER

(4) 500 kcmil-#4 X (4) 3/8 STUDS
1 POLE 600V

700411

SIGN:
DATE:

SIGN:
DATE: