

| REV | DATE | ECO | DESCRIPTION | BY | CK | APP |
|-----|---------|-----|--------------|-----|-----|-----|
| - | 6-10-97 | N/A | INIT RELEASE | DBG | N/A | N/A |

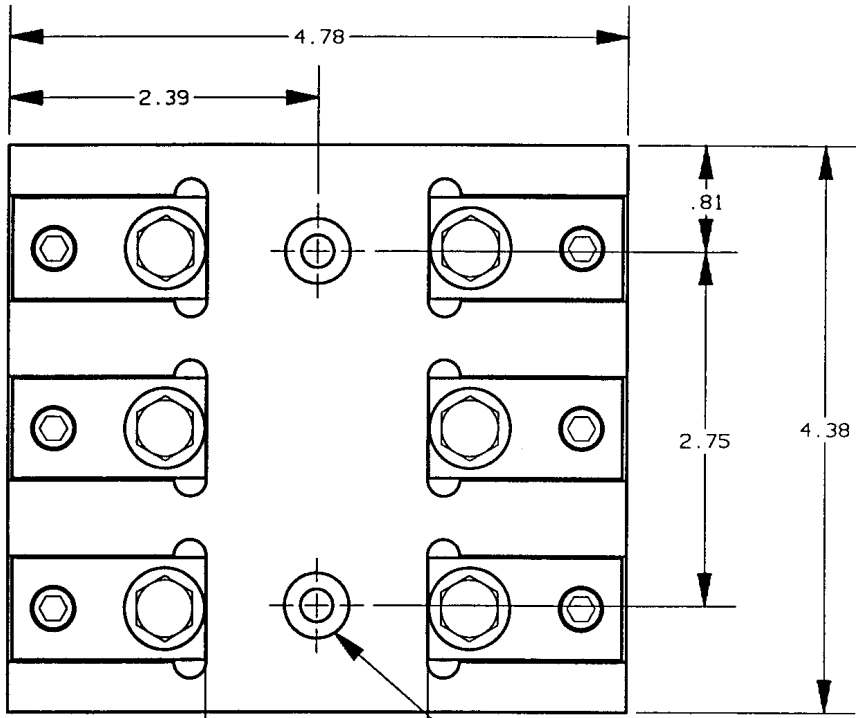

Ø .25 THRU.
C'BORE Ø .50 X
.50 DEEP (2 PLCS)

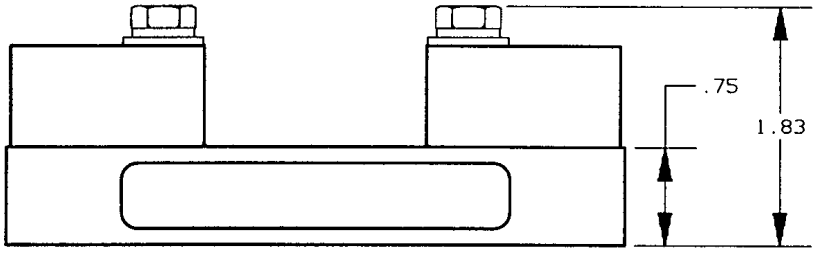

WIRE RANGE
2/0-#14

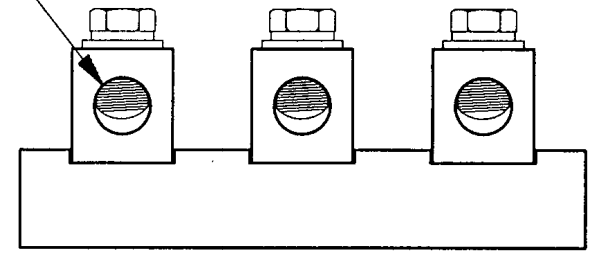

NOTES:

1. UNLESS OTHERWISE SPECIFIED
MATERIAL COMPOSITION AND RATING:
BASE - THERMOSET 150°C RTI
CONNECTOR-ALUMINUM, TIN PLATED.

| P/N | FUSE CLASS | RMS SYM RATING | TORQUE (IN-LBS) | CONNECTOR TYPE | WIRE | | UL | | CSA |
|--------|------------|----------------|-----------------|----------------|------|-------|----------|-----------|------------|
| | | | | | °C | TYPE | FILE NO. | GUIDE NO. | REPORT NO. |
| 61033T | T | 200K | 120 | BOX | 75 | CU-AL | E52283 | IZLT | LR32169 |

GOULD 374 MERRIMAC STREET
NEWBURYPORT, MA 01950

| | |
|--|---|
| PRODUCT MANAGER SIGN: <i>Michael Dula</i> DATE: 6-16-97 | DESIGN ENGINEER SIGN: <i>Steve M. Borg</i> DATE: 6/11/97 |
|--|---|

FUSE, BLOCK 600V-100A
CLASS T
3 POLE

OUTLINE DIMENSIONS
NOT TO BE USED FOR PRODUCTION

700271